

RoHS
COMPLIANT

SPECIFICATIONS

1. Current rating: 3A AC, DC
2. Voltage rating: 250V AC,DC
3. Temperature range: -40°C ~ +105°C
4. Insulation resistance: 1000MΩ Min.
5. Withstanding voltage: 800V AC/ minute.
6. Contact resistance: 10mΩ Max.

Applicable Wires:

AWG#24~#28

Insulation O.D. : 1.60mm MAX

Material: Brass

Plating: Tin plated over nickel

Suitable KR2508 series housing

Q'ty/reel: 10,000PCS

"*"表示重点管控尺寸

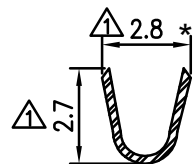
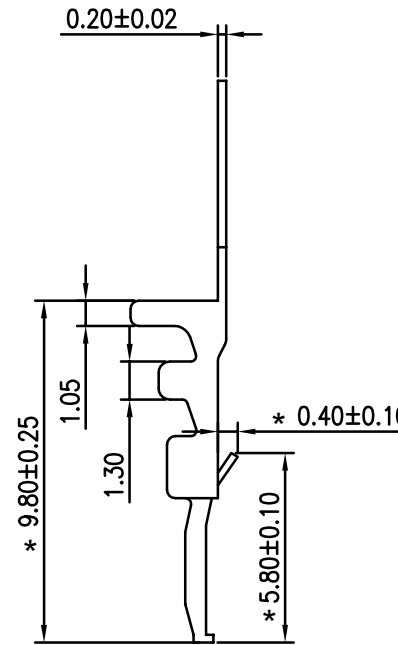
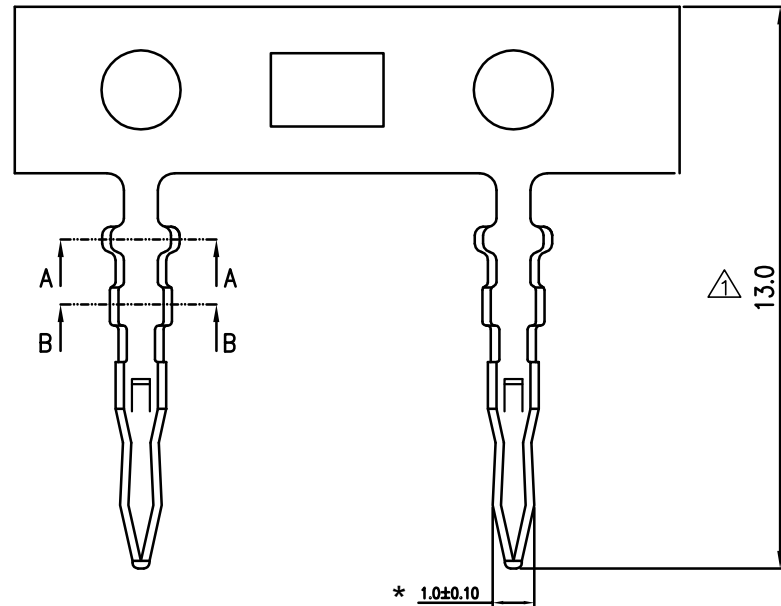

A-A SECTION

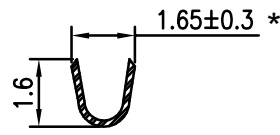

B-B SECTION

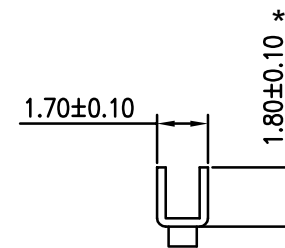

F					TOLERANCE	TITLE:	DRAWN: Liujiangtian 2020.5.06	KONNRA 东莞市康瑞电子有限公司	
		更改料号及图框格式	LJT	2020.05.06	X. X ±0.30 X. XX ±0.20 X. XXX ±0.10 Angle ±2°	SCN2.5 180° Terminal	CHECKED:	DongGuan Konnra Electronics Co., Ltd.	
MARK	REVISION DESCRIPTION	SIGNATURE	DATE		UNIT: mm	SCALE: N/A	SHEET: 1/1	PROJECTION	PART NO. : T2508VBT0101A
	1	2	3	4	5	6	7	8	9