

RoHS  
COMPLIANT

◆ SPECIFICATIONS

- Current rating: 2.5A AC, DC
- Voltage rating: 250V AC, DC
- Temperature range: -40°C ~ +105°C
- Insulation resistance: 1000MΩ Min.
- Withstanding voltage: 500V AC/ minute.
- Contact resistance: 20mΩ Max.

Material:

Insulator: PA6T UL 94V-0(2-10P)  
LCP UL 94V-0(11-15P)

Contact: Brass

Plating: Tin plated or gold flash over Nickel

Suitable: KR1500 series Housing

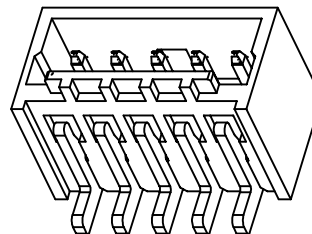

3D View

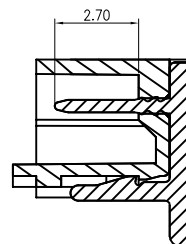
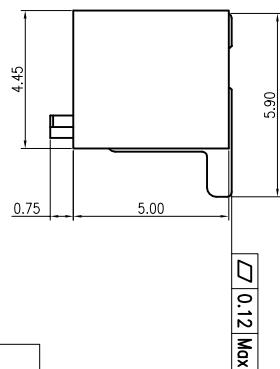
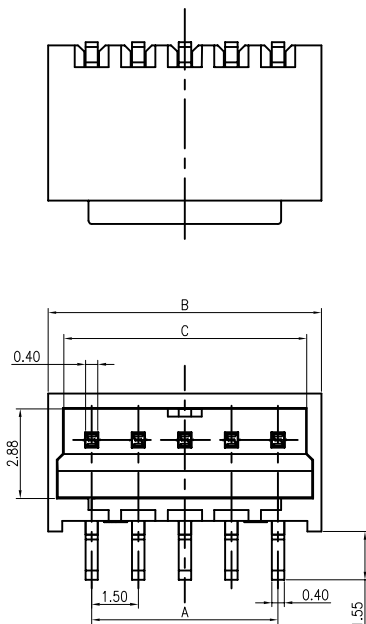

C1500VS1\*\*09M0101RA  
 02: 2P  
 16: 16P  
 09: PA6T本色  
 13: LCP本色  
 M01: 雾锡  
 G01: 漂金  
 R: 卷装  
 P: 袋装

Dimensions			
Pin	A	B	C
2P	1.50	4.30	3.35
3P	3.00	5.80	4.85
4P	4.50	7.30	6.35
5P	6.00	8.80	7.85
6P	7.50	10.30	9.35
7P	9.00	11.80	10.85
8P	10.50	13.30	12.35
9P	12.00	14.80	13.85
10P	13.50	16.30	15.35
11P	15.00	17.80	16.85
12P	16.50	19.30	18.35
13P	18.00	20.80	19.85
14P	19.50	22.30	21.35
15P	21.00	23.80	22.85

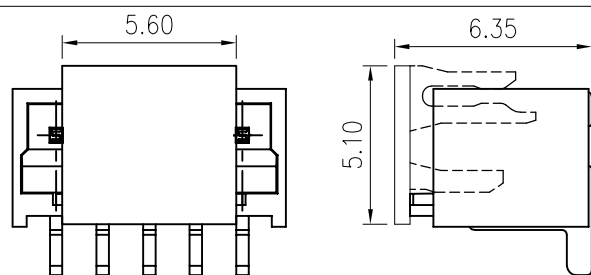

WITH CAP VIEW

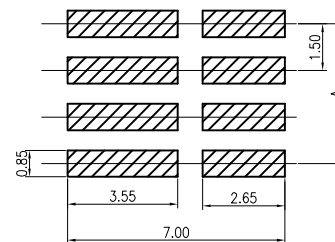

P.C.Board Layout



更改料号及图框格式

Ru yi

2020.3.10

TOLERANCE

TITLE:

DRAWN: ru yi 2020.03.10

KONNRA 东莞市康瑞电子有限公司



11-15P 变更材质

Arvin

2019.03.13

X.X ±0.30

MX 1.5 SMT 180° Wafer

CHECKED:

DongGuan Konnra Electronics Co.,Ltd.



新发行

Arvin

2016.03.13

X.XX ±0.20

APPROVED:

PART NO.: C1500VS1\*\*\*\*M01\*\*RA

MARK

REVISION DESCRIPTION

SIGNATURE

DATE

X.XXX ±0.10

UNIT: mm SCALE: N/A

SHEET: 1/1 PROJECTION

REV.: A3

DRAWING NO.: 1500WS01-A-S

Angle ±2°